

二色発光 Two Color Lighting

□ 15.0 mm × 12.0 mm Series

Type No. Lighting Color
 LN0801WP23.....Red, Green
 LN0801WP38.....Green, Orange

絶対最大定格 Absolute Maximum Ratings (Ta=25 °C)

Lighting Color	P _D (mW)	I _F (mA)	I _{FP} (mA)*	V _R (V)	Topr (°C)	Tstg (°C)
Red	60	20	100	4	-25~+80	-30~+85
Green	60	20	100	4	-25~+80	-30~+85
Orange	60	20	100	3	-25~+80	-30~+85

* I_{FP}の条件は、 duty 10%, Pulse width 1 msec. The condition of I_{FP} is duty 10%, Pulse width 1 msec

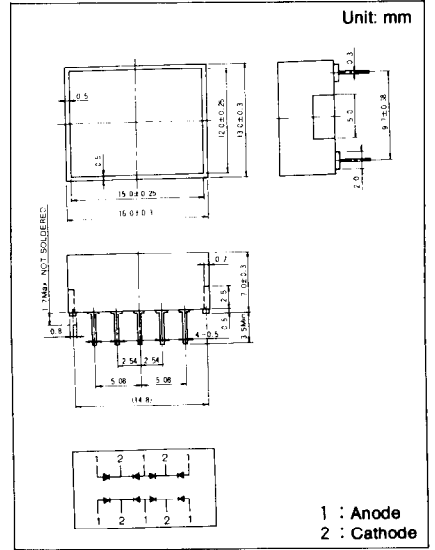

電気的光学的特性 Electro-Optical Characteristics (Ta=25 °C)

Type No.	Lighting Color	Lens Color	I _O			V _F		λ _P	Δλ	I _F	I _R	
			Typ.	Min.	I _F	Typ.	Max.	Typ.	Typ.		I _F	Max.
LN0801WP23	Red	White Diffused	4.0	1.2	10	2.2	2.8	700	100	20	10	4
	Green		8.0	2.5	10	2.2	2.8	565	30	20	10	4
LN0801WP38	Green	White Diffused	8.0	2.5	10	2.2	2.8	565	30	20	10	4
	Orange		8.0	2.5	10	2.1	2.8	630	40	20	10	3
Unit	—	—	mcd	mcd	mA	V	V	nm	nm	mA	μA	V

